

York County shore.

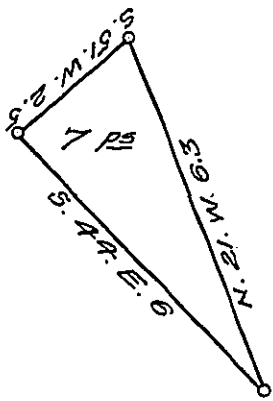

Lancaster County Shore

A Draught of Maple Island Situate in the River Susquehanna Little Britain Township Lancaster County opposite the land of Stephen T. Cooper on the York County shore about fifty perches above Rock Island Containing seven perches Strict Measure, surveyed in pursuance of a Warrant dated the 11th day of September A.D. 1815 granted to John Kirk.

p^c Jacob Hibshman D.S.

To Jacob Spangler Esq^r }
 Surveyor General }

IN TESTIMONY that the above is a copy of the original remaining on file in the Department of Internal Affairs of Pennsylvania, made conformably to an Act of Assembly approved the 16th day of February, 1833, I have hereunto set my Hand and caused the Seal of said Department to be affixed at Harrisburg, this thirty first day of January 1908.

Henry Honck
 Secretary of Internal Affairs.